

4

# Industrial & Workshop Hydraulics

## Workshop Presses

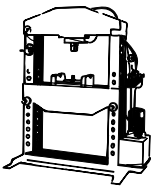

4



HWPHP 15/20,  
30 t plus, with cable winch

### HWPHP Workshop Presses with hand pumps

Reliability makes the difference. Anyone needing a rugged workshop press with hand pump with pressing power of 50 t for repair and assembly work will always turn to the HWPHP. Whether for pressing bearings and bushes in and out, straightening axles, beams and shafts or bending, pressing and setting up tools ...this technology offers the perfect solution. It comes with an automatic piston return, 2-level hand pump, adjustable pick-up table, quick-elevating system and chrome-plated, hardened pistons. The HWPHP press with hand pump has an optimum transmission ratio, meaning that large lifting distances are covered with just a few pump movements.

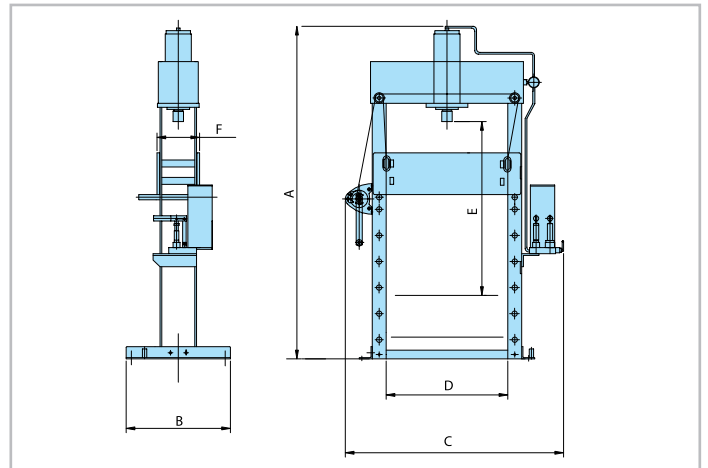

Accessories for HWPHP 15 and 20 t included in delivery items. Other versions available on request.



Prism set

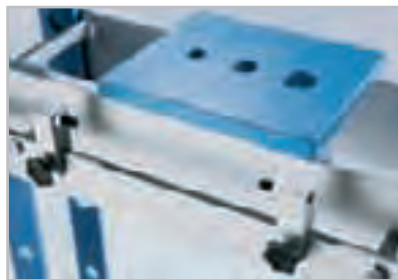

Base plate



Centering device

Type			HWPHP 15 040012730	HWPHP 20 040012731	HWPHP 30 040012732	HWPHP 40 040012733	HWPHP 50 040012734
Art. No.							
Pressing Power		t	15	20	30	40	50
Operating pressure		bar	240	320	250	330	330
Lifting height		mm	190	190	190	190	190
Total height	A	mm	1870	1870	1920	2010	2030
Total depth	B	mm	500	500	600	780	850
Total width	C	mm	940	940	1260	1335	1350
Clear working width	D	mm	550	550	700	775	775
Clear working height	E	mm	940	940	1000	1125	1155
Table width	F	mm	185	185	245	258	304
Net weight		kg	150	150	250	310	420

Intended use: A workshop press/straightening press is a press which has a slow closing speed of 10 mm/second and a maximum pressing capacity of 10 full load/full lift presses per hour.

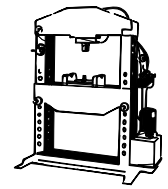

## Workshop Presses

### HWPEP Workshop Presses with electric pumps

Compressed productivity in press form for repair and assembly work. This is what the workshop press offers with its reliable 1- or 2-level electric pump and pressing power of up to 100 metric tons. Whether you are pressing bearings and bushes in and out, straightening axles, beams and shafts, or bending, pressing or setting up tools ... the high performance of this press is based on optimized technology. For example, the press comes with a high pressure unit with a manometer, a control valve and three-way valve, an adjustable pick-up table and high-quality pistons made of chrome-plated hardened and tempered special steel.

Accessories available as options (see page 66)



HWPEP-1 50



Detail of cable winch

4

#### Workshop press – with 1-level electric pump

Type			HWPEP-1 30	HWPEP-1 40	HWPEP-1 50	HWPEP-1 100
Art. No.			040012735	040012736	040012737	040012738
Pressing Power	t		30	40	50	100
Operating pressure	bar		250	330	330	320
Lift	mm		260	260	260	300
Total height	A	mm	1920	2010	2030	2170
Total depth	B	mm	660	780	850	1000
Total width	C	mm	1240	1315	1410	1700
Clear working width	D	mm	700	775	775	1000
Clear working height	E	mm	1000	1125	1155	1075
Table width	F	mm	245	258	300	415
Operating lifting speed	cm/s		0,51	0,51	0,41	0,29
Motor data			400 V 1,5 kW			400 V 3 kW
Load factor			S3-30%*			
Net weight	kg		280	340	450	920

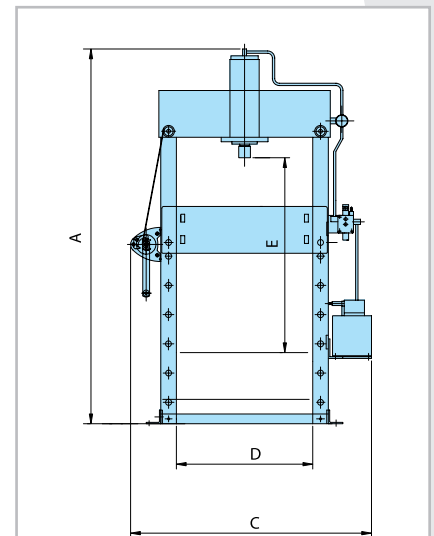

#### Workshop press – with 2-level electric pump

Type			HWPEP-2 30	HWPEP-2 40	HWPEP-2 50	HWPEP-2 100
Art. No.			040012739	040012740	040012741	040012742
Pressing Power	t		30	40	50	100
Operating pressure	bar		250	330	330	320
Lift	mm		260	260	260	300
Total height	A	mm	1920	2010	2030	2170
Total depth	B	mm	660	780	850	1000
Total width	C	mm	1240	1315	1460	1700
Clear working width	D	mm	700	775	775	1000
Clear working height	E	mm	1000	1125	1155	1075
Table width	F	mm	245	258	300	415
Level 1/ Overdrive	cm/s		2,16	2,16	2,5	2,44
Level 2/ Operating speed	cm/s		0,42	0,42	0,34	0,29
Motor data			400 V 2,2 kW			400 V 3 kW
Load factor			S3-30%*			
Net weight	kg		280	340	450	920

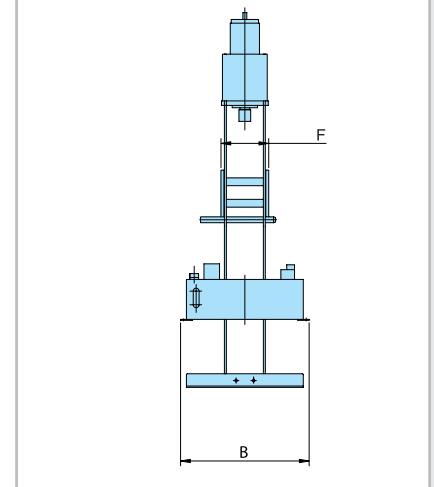

\* 10 lifting cycles per hour; max. 6 sec. with pressure control valve for each lifting cycle  
Intended use: A workshop press/straightening press is a press with a slow closing speed of 10 mm/ and a maximum pressing capacity of 10 full load/full lift presses per hour.

# Industrial & Workshop Hydraulics

## Workshop Cranes SILVERLINE

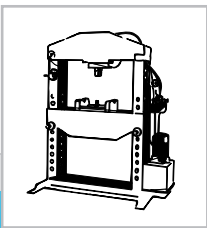

4

### SILVERLINE HWK KLS Workshop Crane

Power really can be this comfortable. When adaptability is required, the HWK KLS workshop crane is the master of versatility. In both versions for either 0,5 t or 1,0 t lifting capacity, both with a parallel or V-shaped chassis, you have a device to cope with every conceivable workshop requirement. The rotatable hydraulic system provides for absolute operating convenience even in confined spaces. Moreover, the pump raises the cantilever arm to a height of 2080 mm in overdrive with just 20 pump movements. And it does all this with the utmost safety, thanks to the specially designed chassis and the parking wheel brake supplied as standard which hold the crane firmly in position. Once the job has been completed the crane can be quickly and easily folded together and stored away by just one person.



HWK KLS with chassis form V



HWK KLS with chassis form II

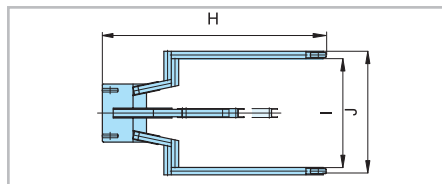

Chassis form II

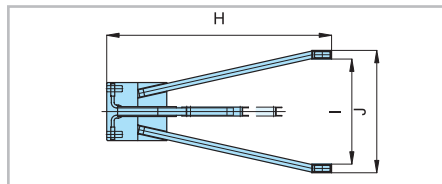

Chassis form V

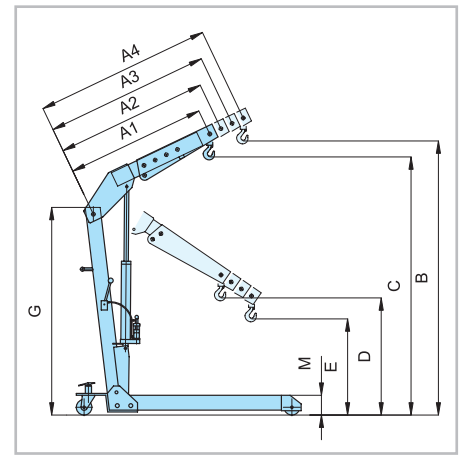

Art. No.			040008514	040008515	040008516	040008517
Type			HWK KLS 0,5	HWK KLS 0,5	HWK KLS 1,0	HWK KLS 1,0
Chassis form			II	V	II	V
Lifting capacity at crane arm length	kg/mm A1		500/1130	500/1130	1000/1130	1000/1130
	kg/mm A2		400/1230	400/1230	800/1230	800/1230
	kg/mm A3		350/1330	350/1330	700/1330	700/1330
	kg/mm A4		250/1430	250/1430	500/1430	500/1430
Hook height at max. outermost position	mm C		2200	2200	2200	2200
Hook height at max. innermost position	mm B		2080	2080	2080	2080
Hook height at min. outermost position	mm E		770	770	770	770
Hook height at min. innermost position	mm D		940	940	940	940
Lift per pump movement, with/without load	mm		20/80	20/80	20/80	20/80
Operating pressure	bar		150	150	290	290
Hand power under nominal load	daN		16	16	32	32
Drive through height	mm G		1680	1680	1680	1680
Underclearance height	mm M		160	160	160	160
Chassis length, total	mm H		1820	1820	1820	1820
Chassis width, inside/outside	mm I/J		990/850	990/850	990/850	990/850
Net weight	kg		138	132	156	150